

CONNECTIVITY AT EUROPEAN LEVEL

-  INTERNATIONAL HUB
-  HARBOUR

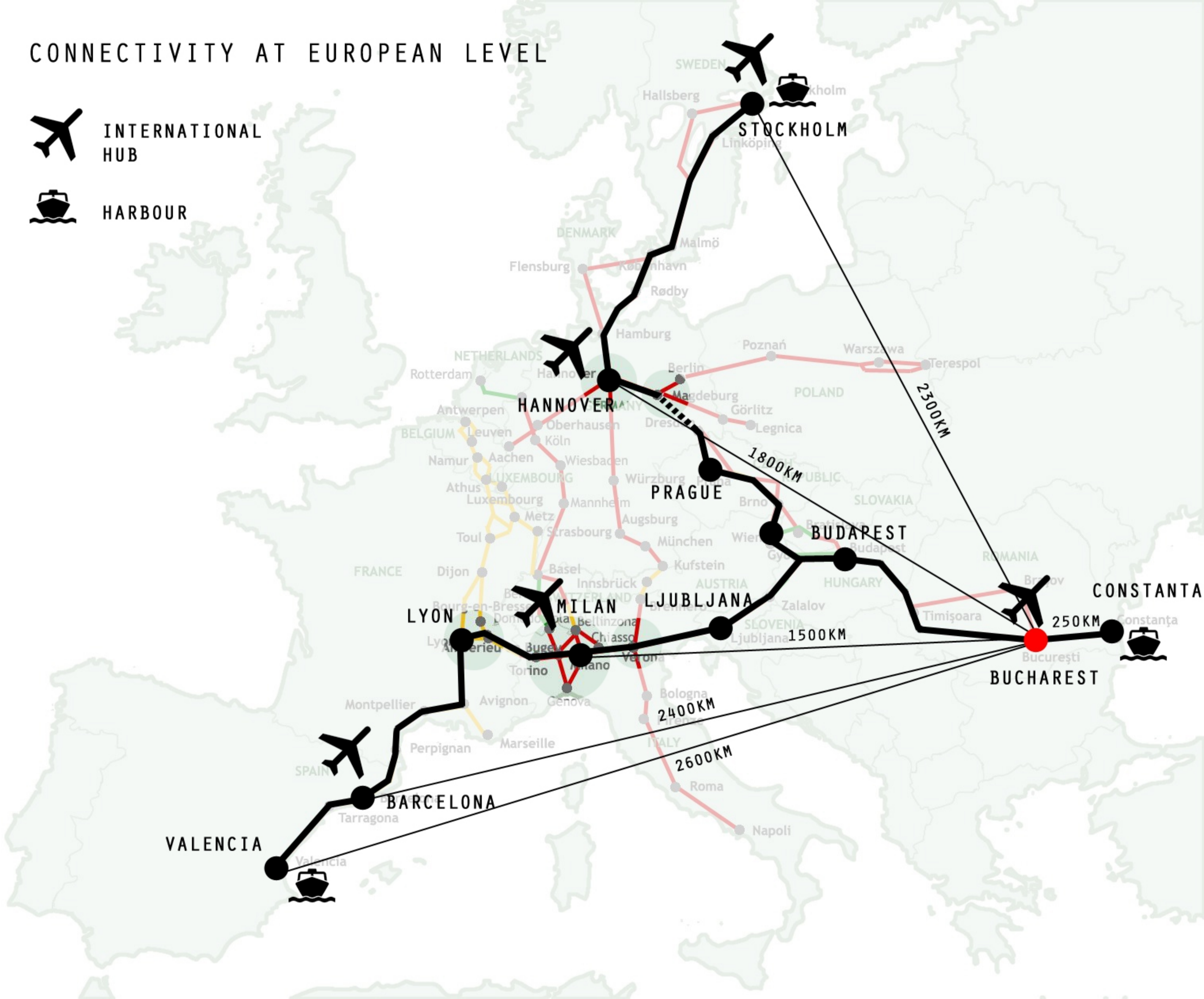

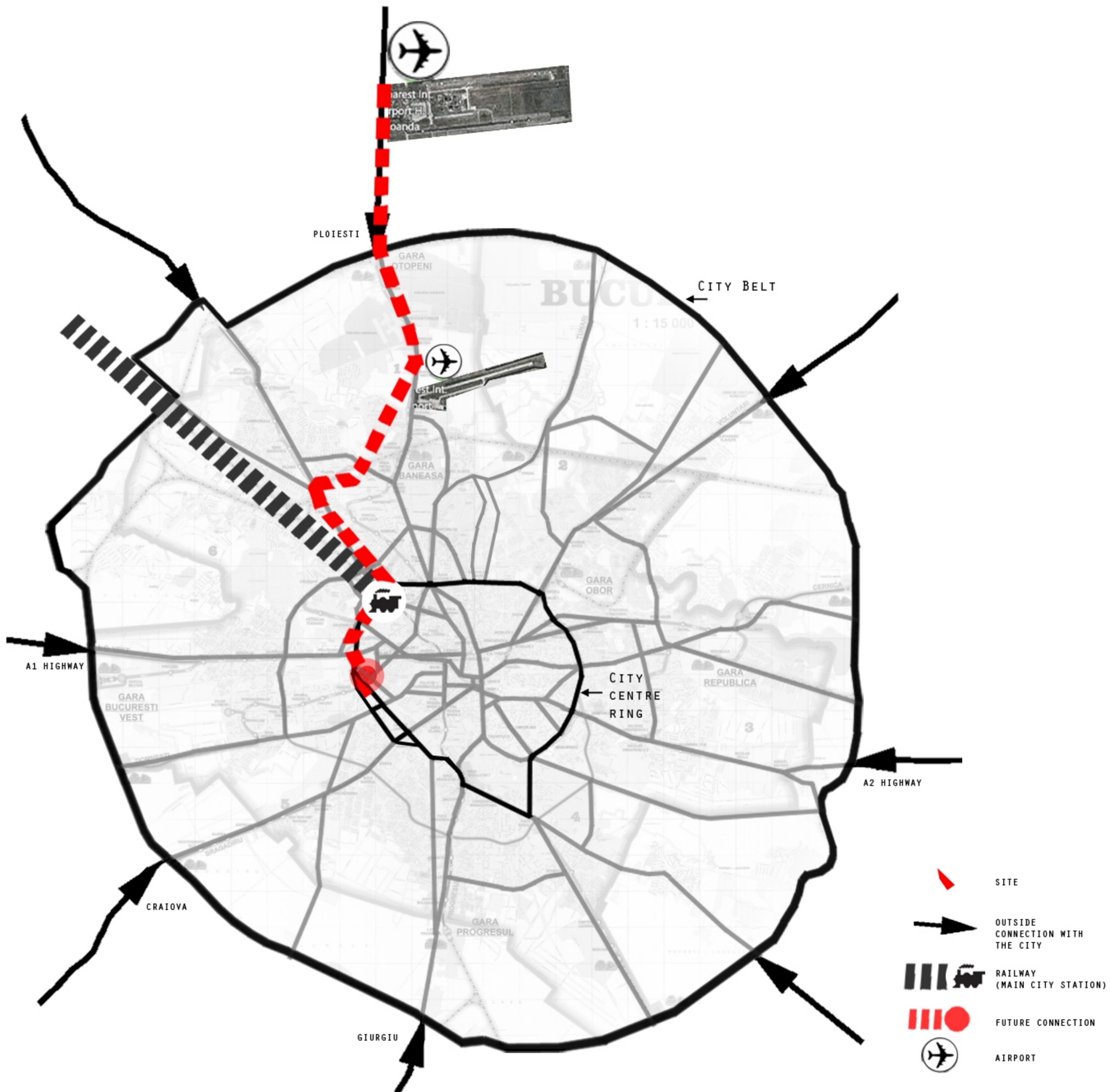

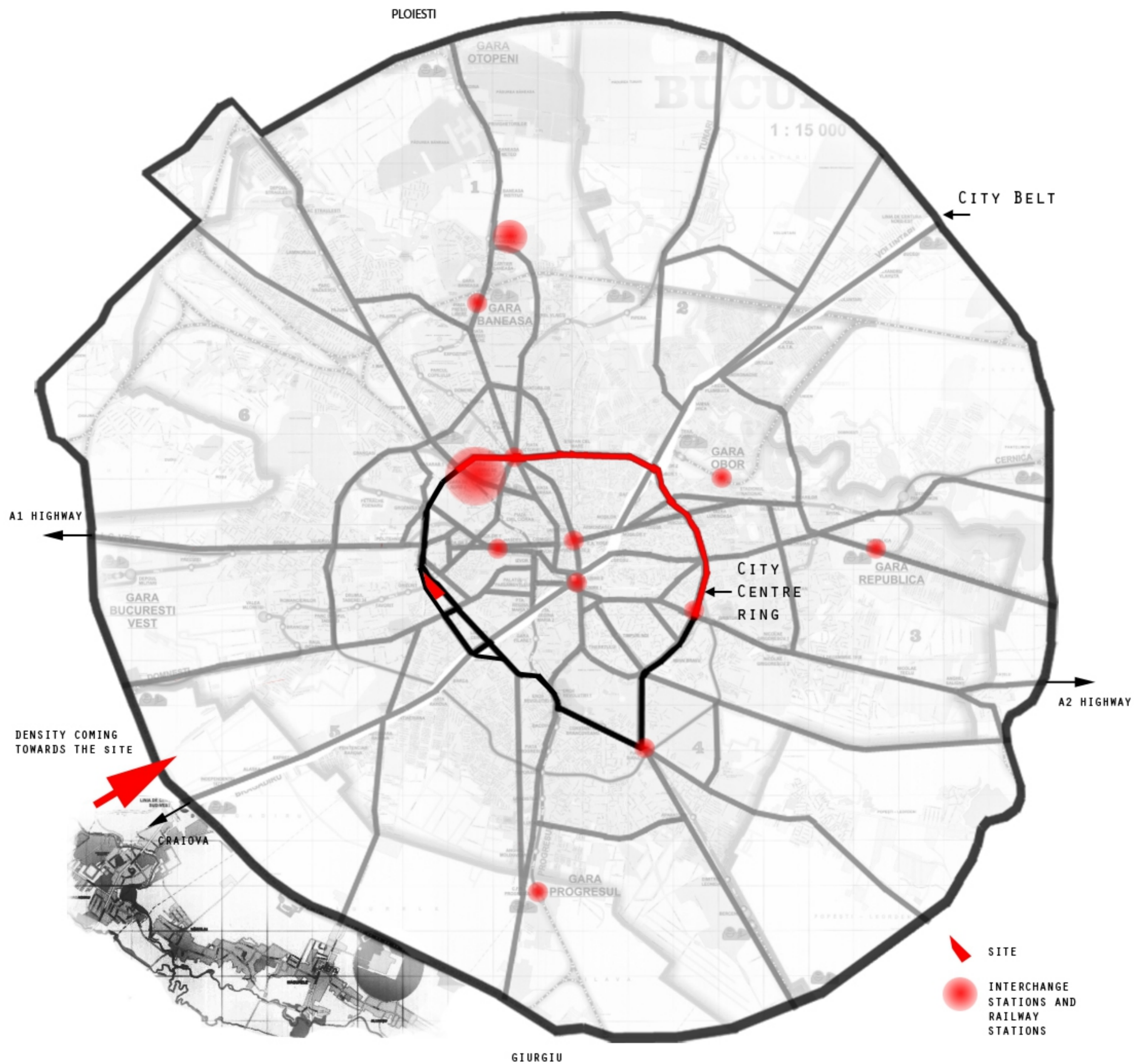



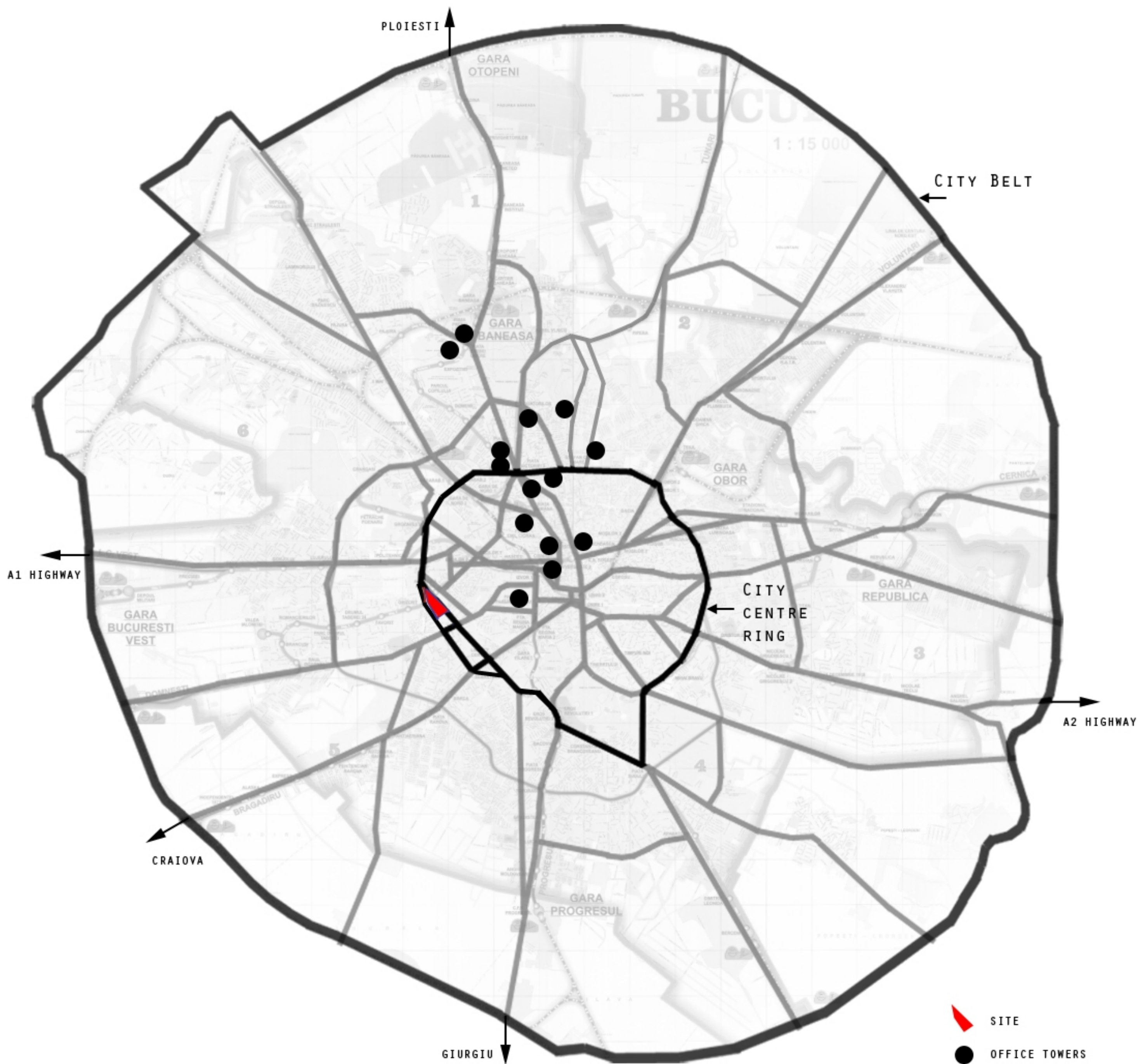

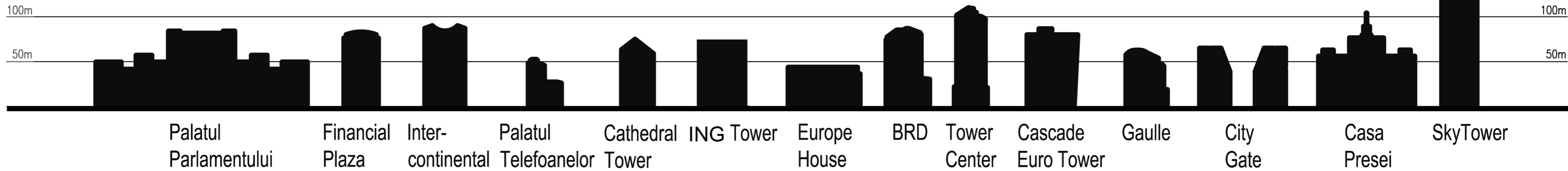

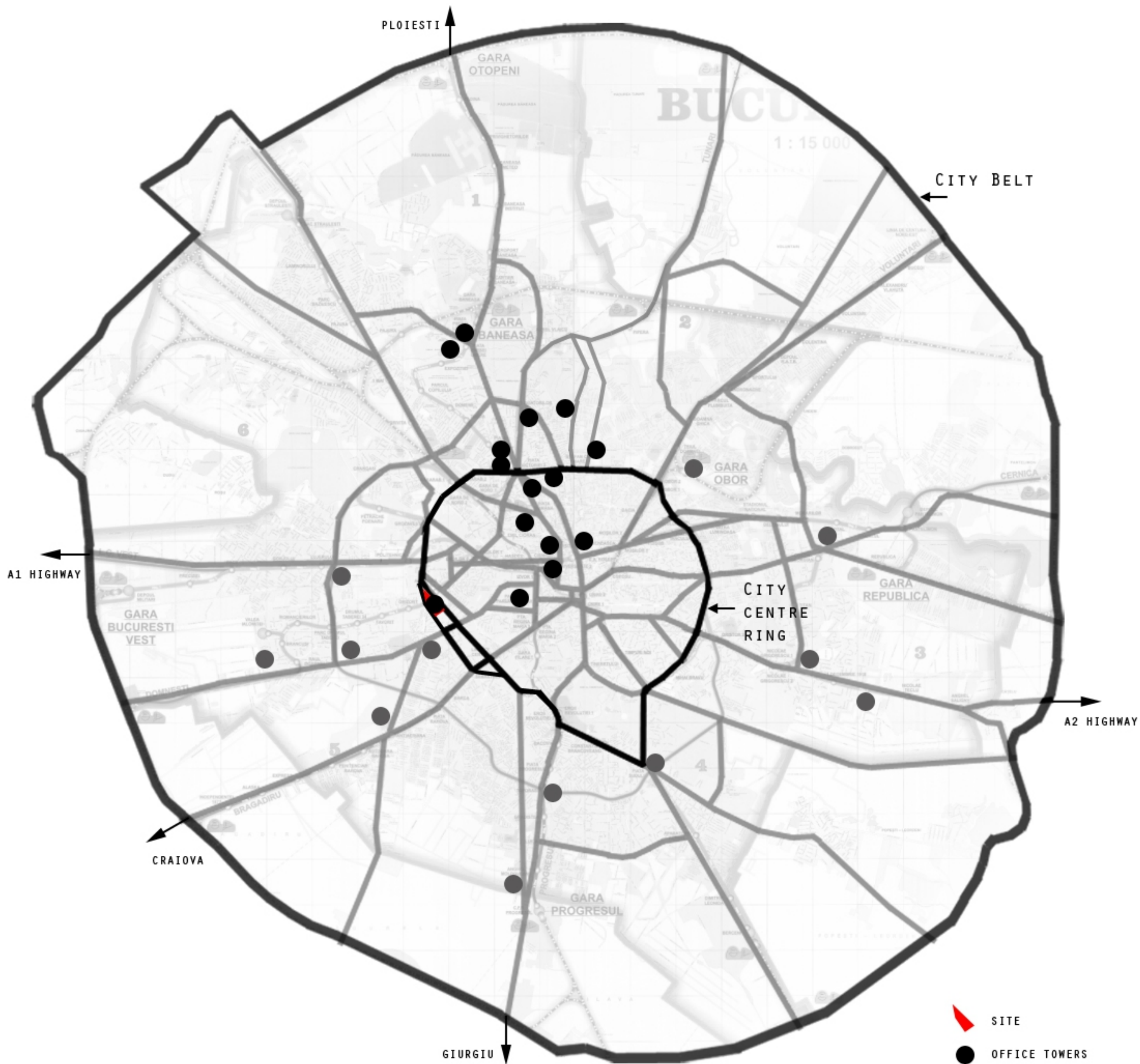

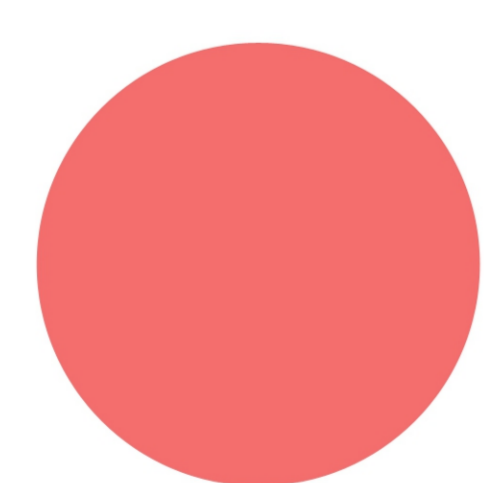
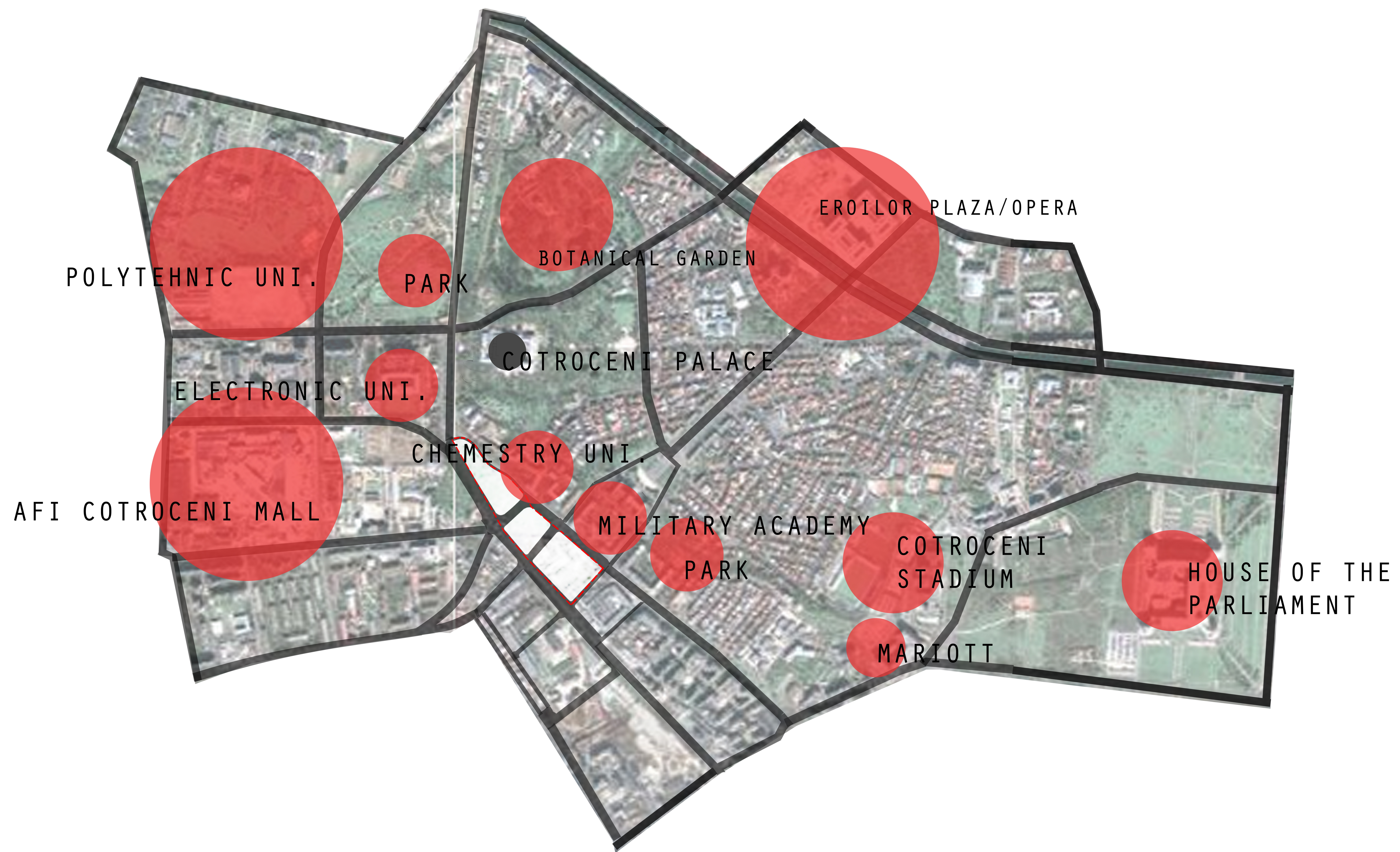

ATTRACTION POLE

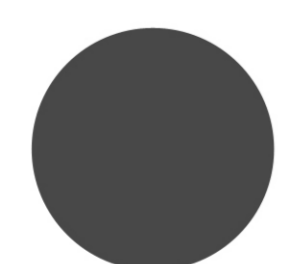

LANDMARK

PEDESTRIAN AND TRAFFIC MIGRATION

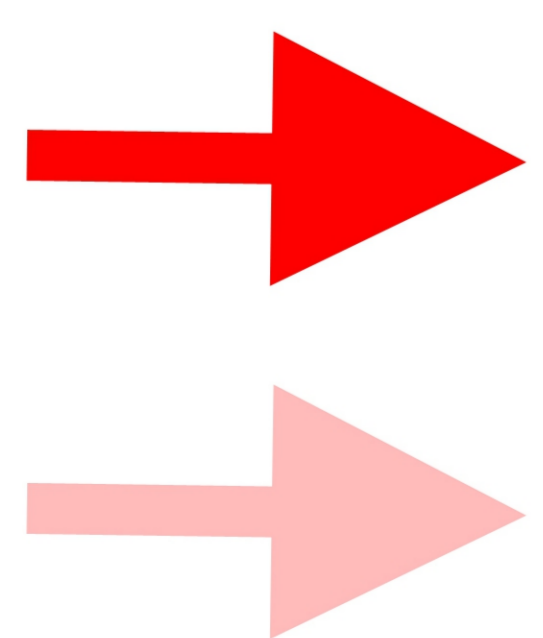
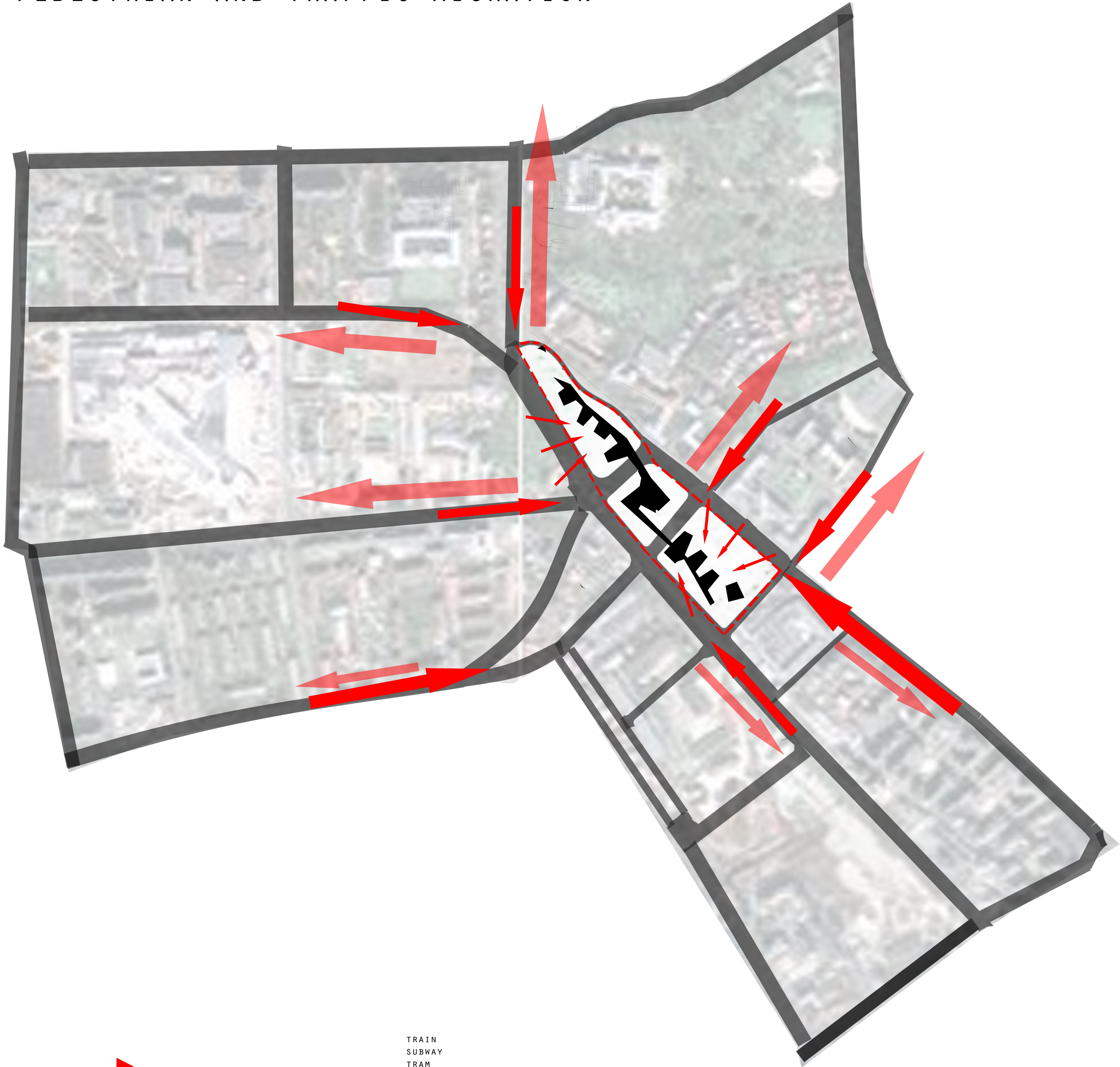

FLUXES ENTERING THE SITE  
PUBLIC TRANSPORT  
PRIVATE TRANSPORT  
FLUXES LEAVING THE SITE

- TRAIN
- SUBWAY
- TRAM
- BUS
- TROLEY BUS
- CAR
- BIKE
- PEDESTRIAN

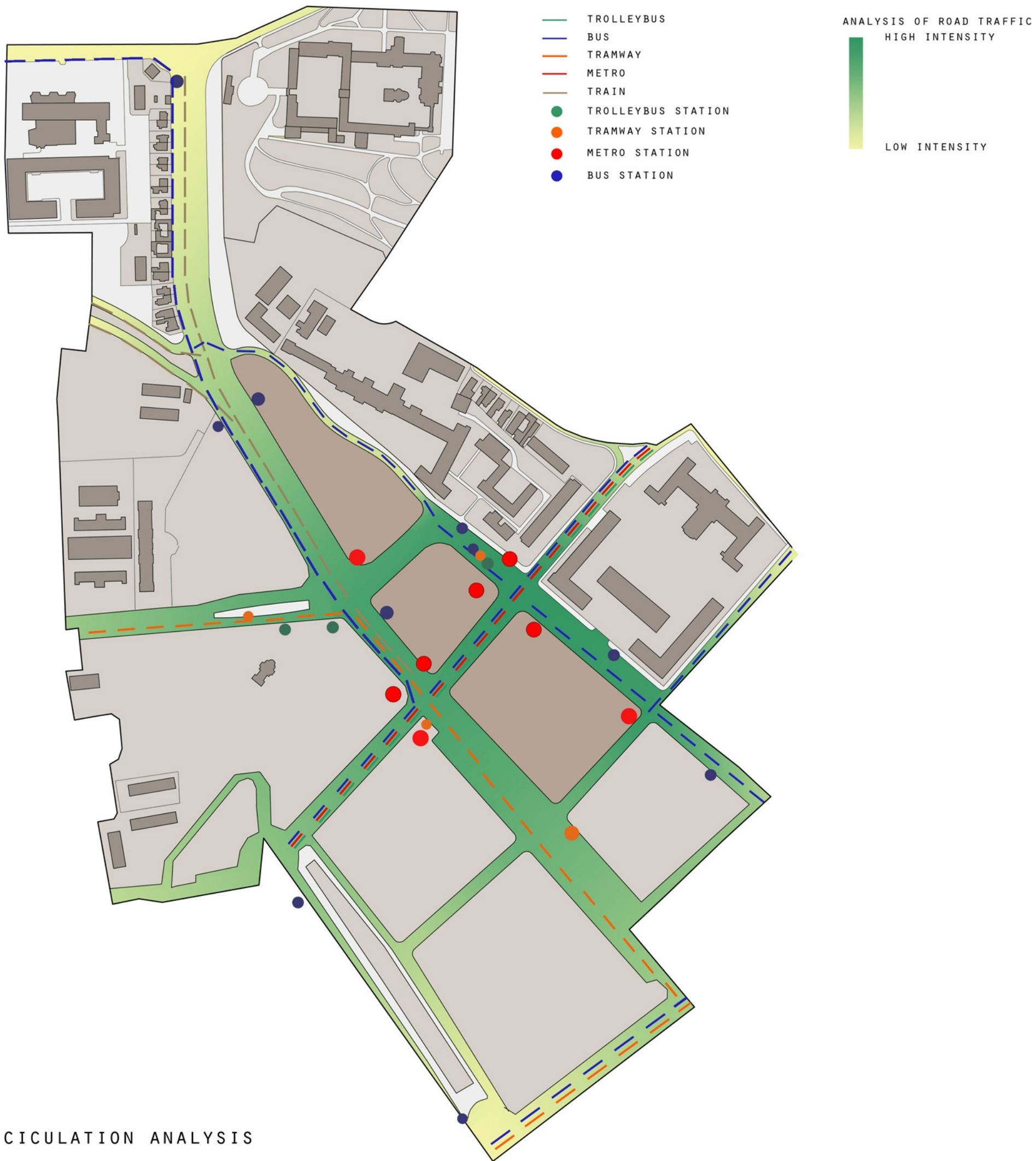

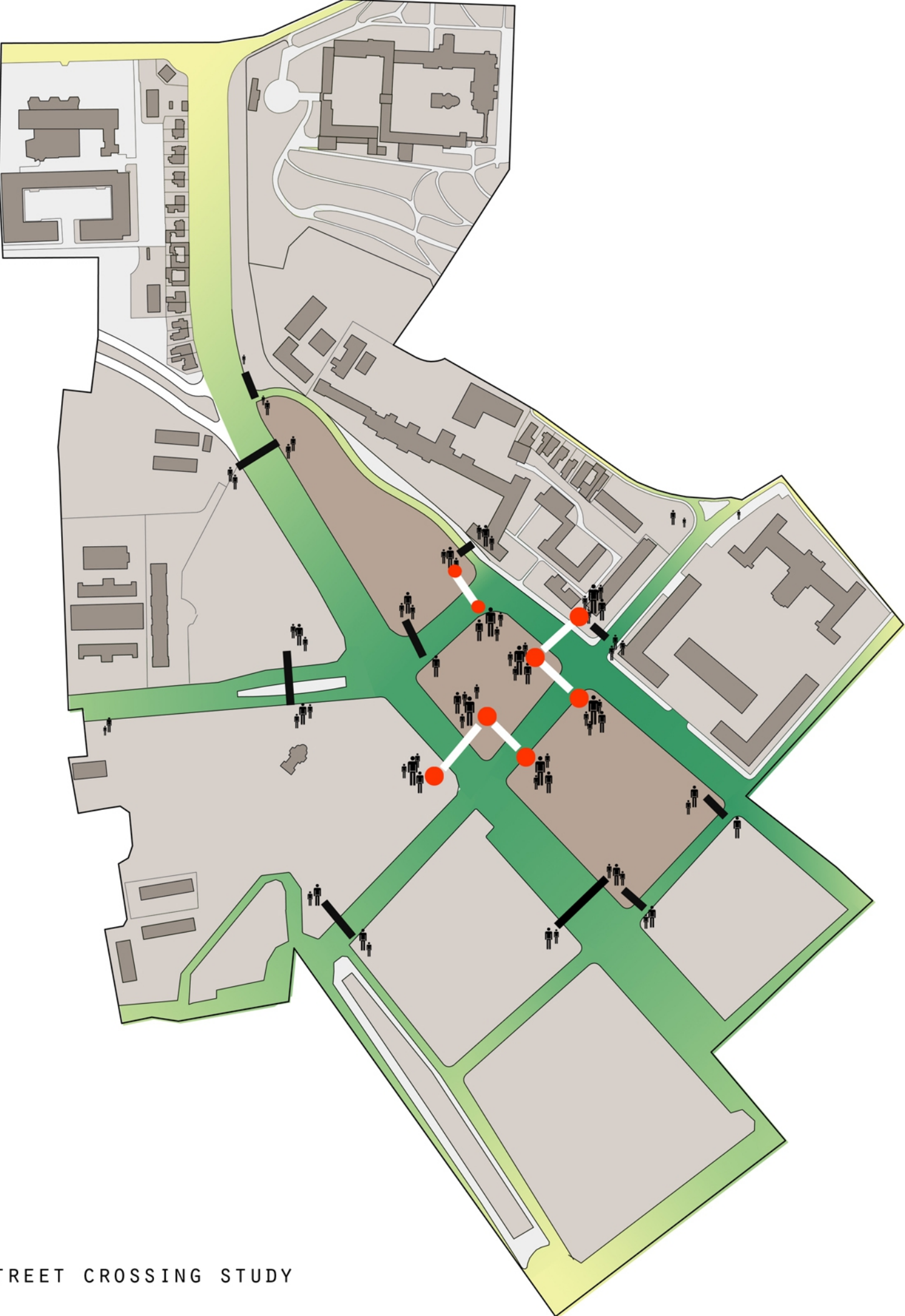

STREET CROSSING STUDY

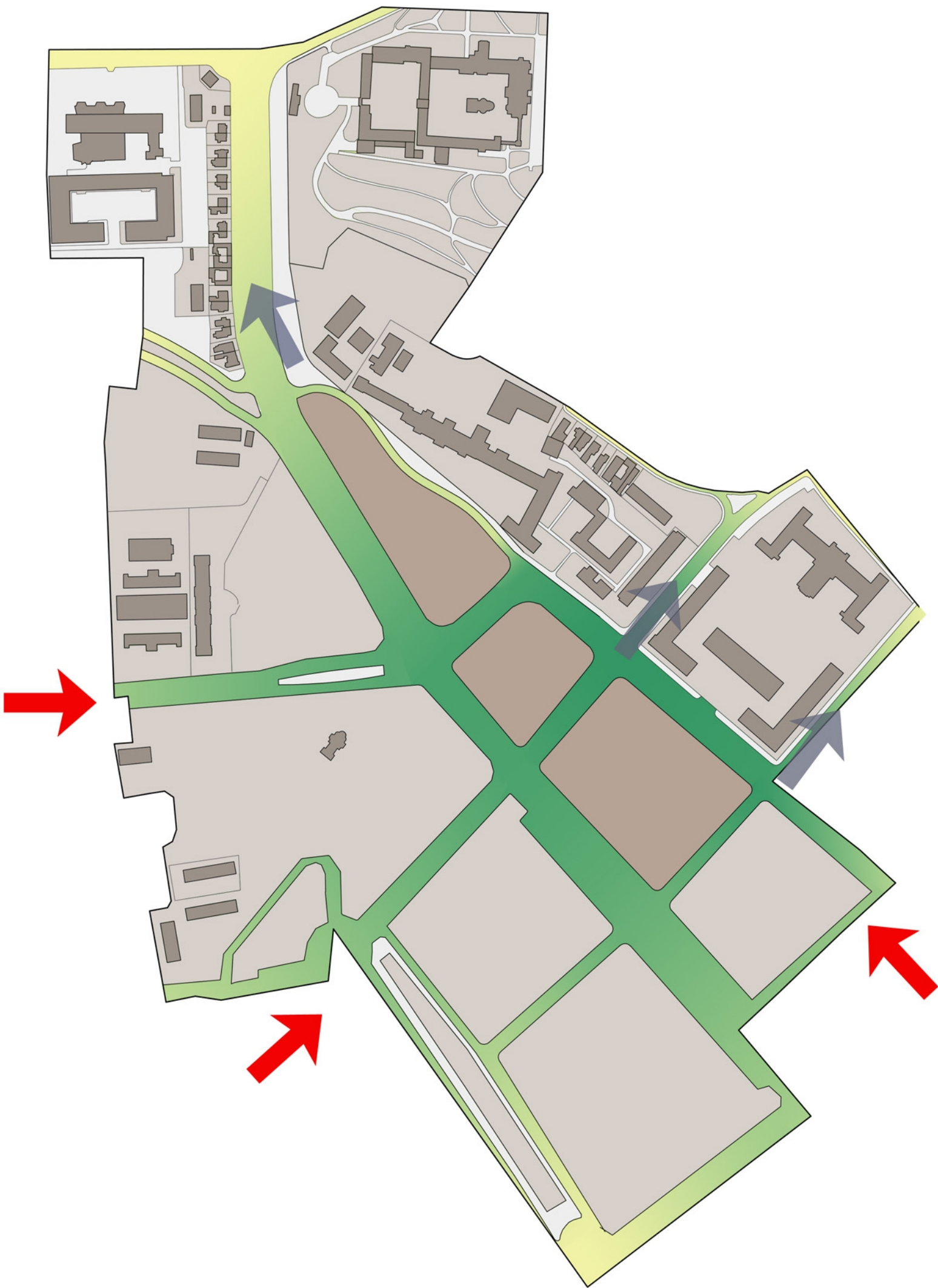

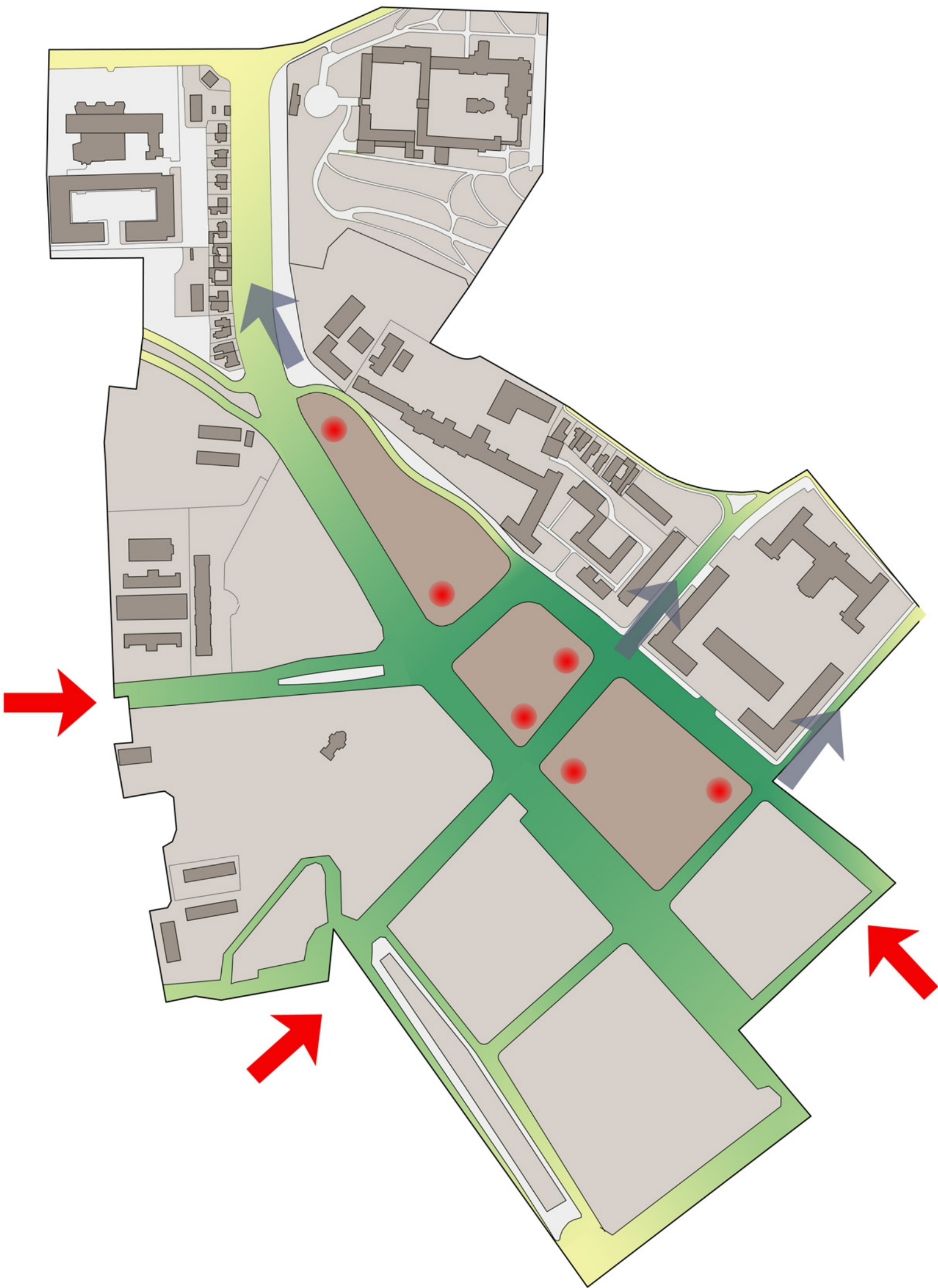

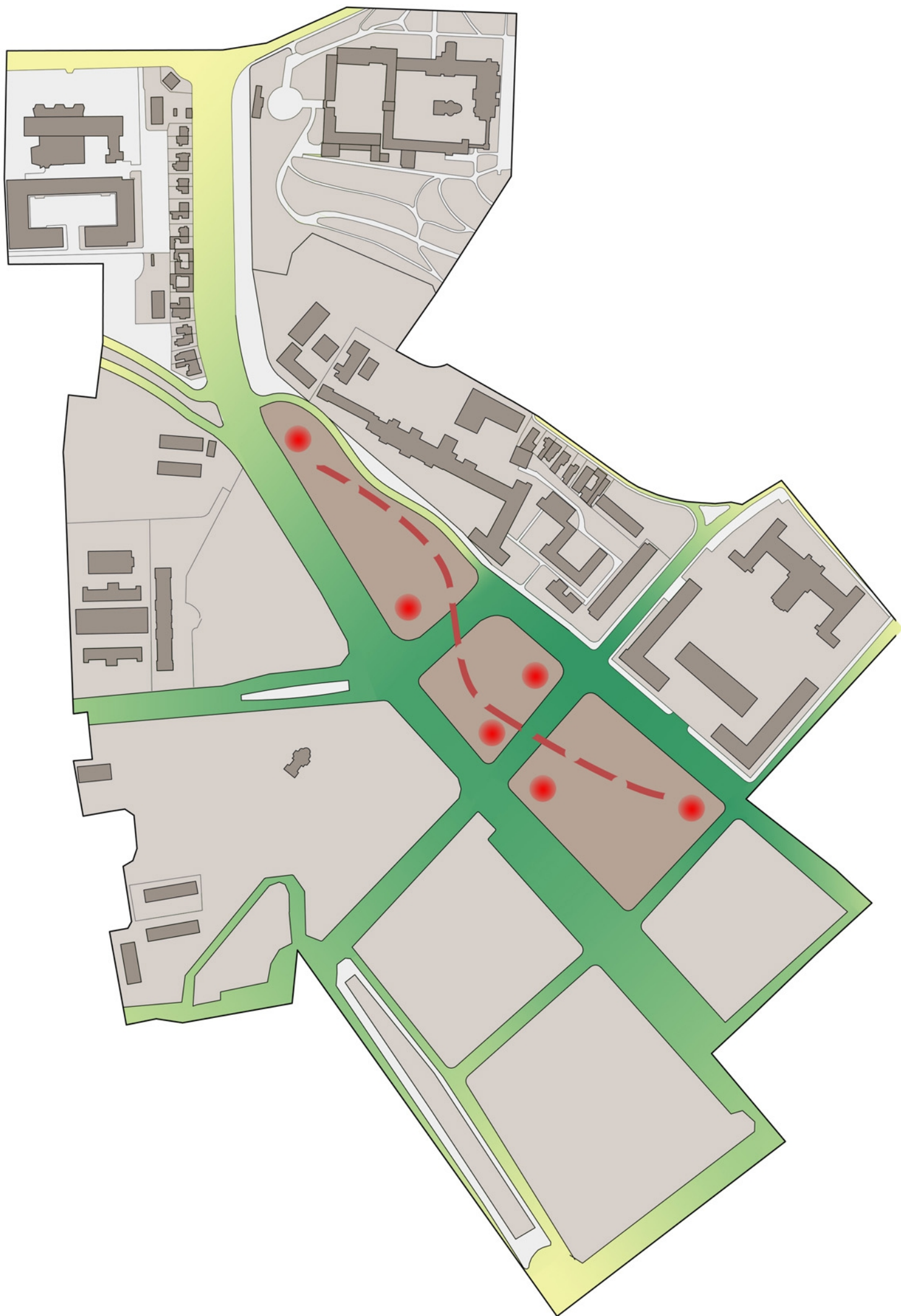

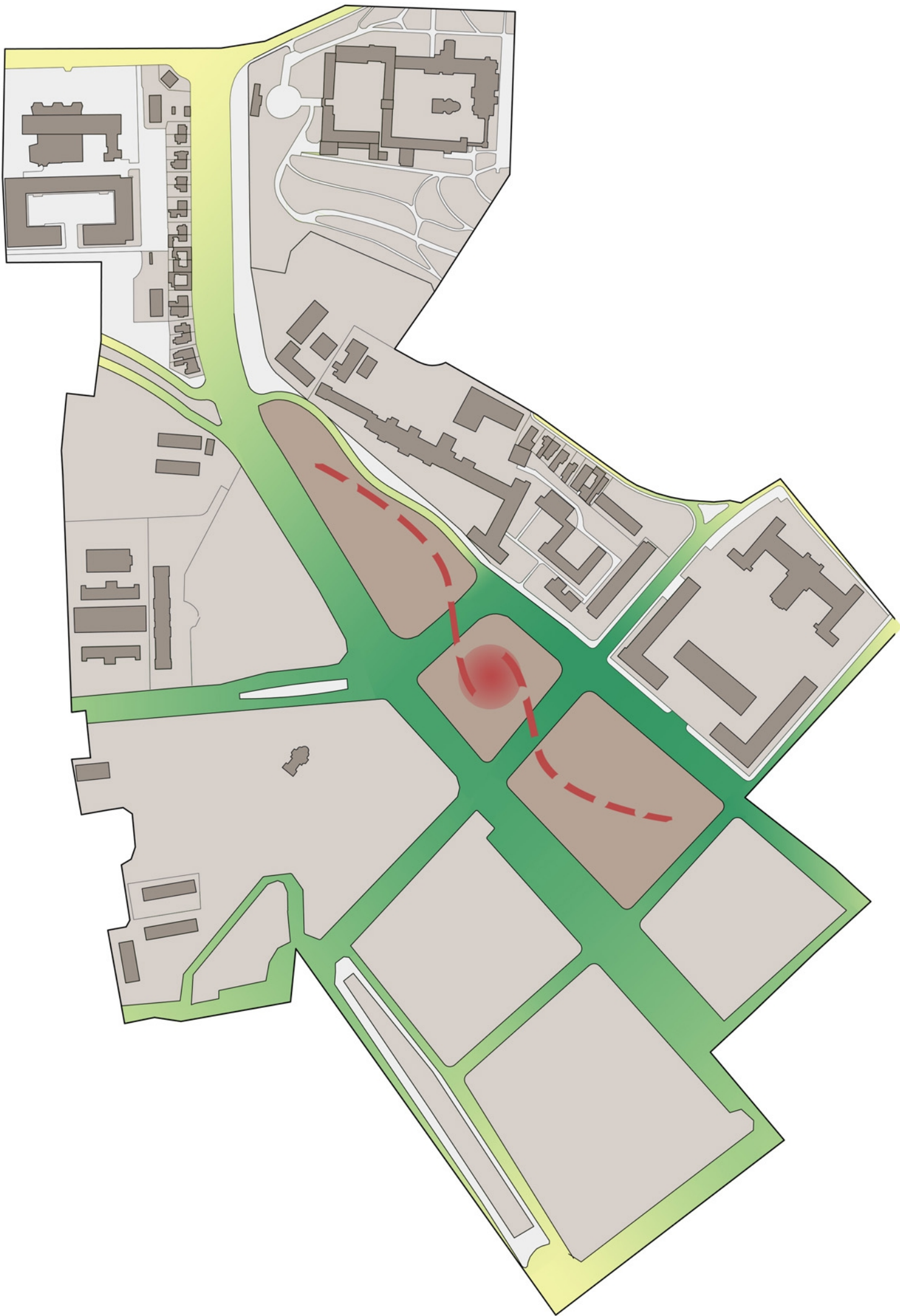

FUNCTIONS

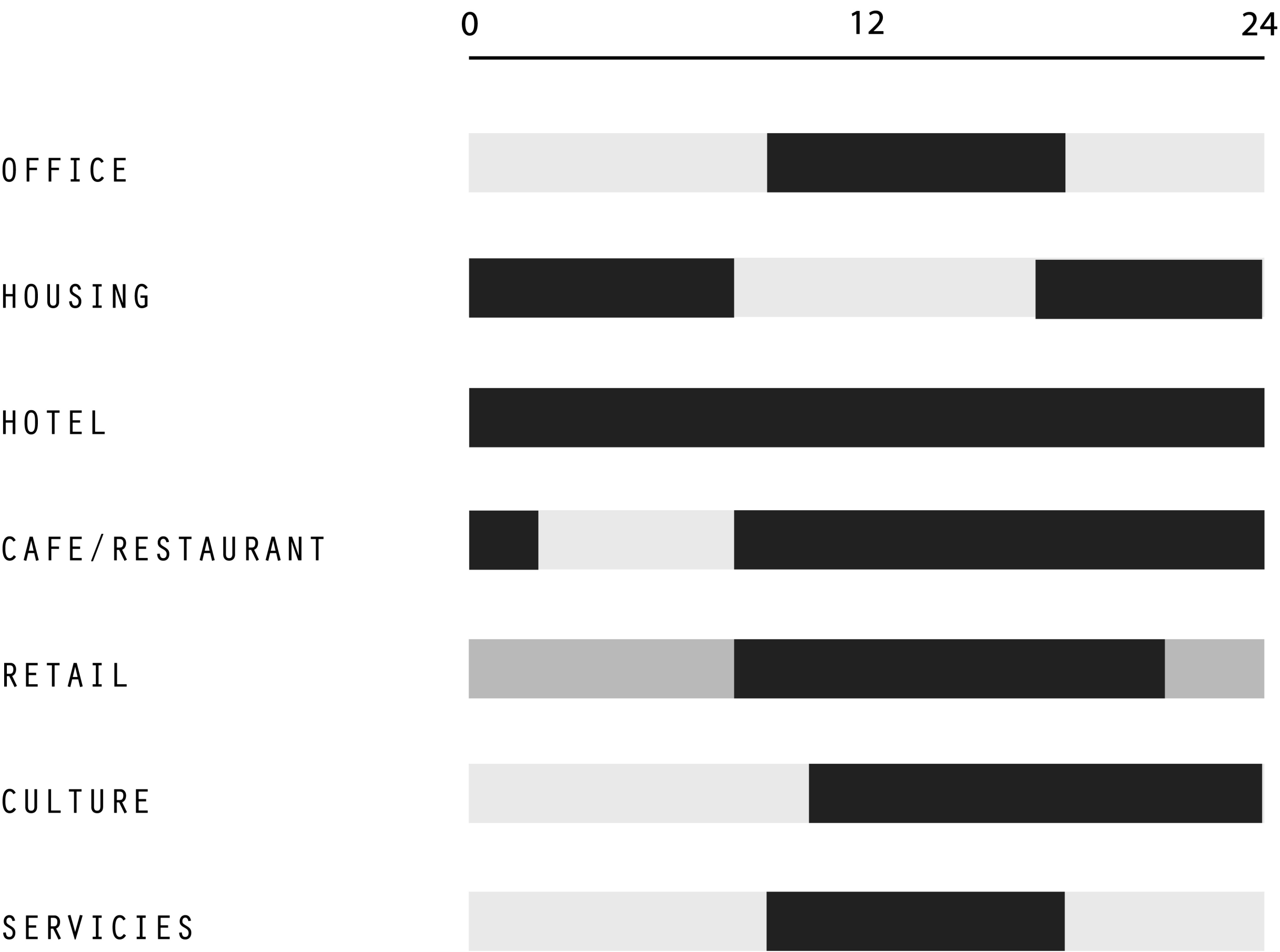

CONCLUSION: THE DISTRIBUTION OF FUNCTIONS DURING ONE DAY  
CICLE SI WELL BALANCED AND IT ENSURES THE SITE WILL BE  
OCCUPIED DURING THE DAY AND THE NIGHT.

FUNCTIONAL SCHEME

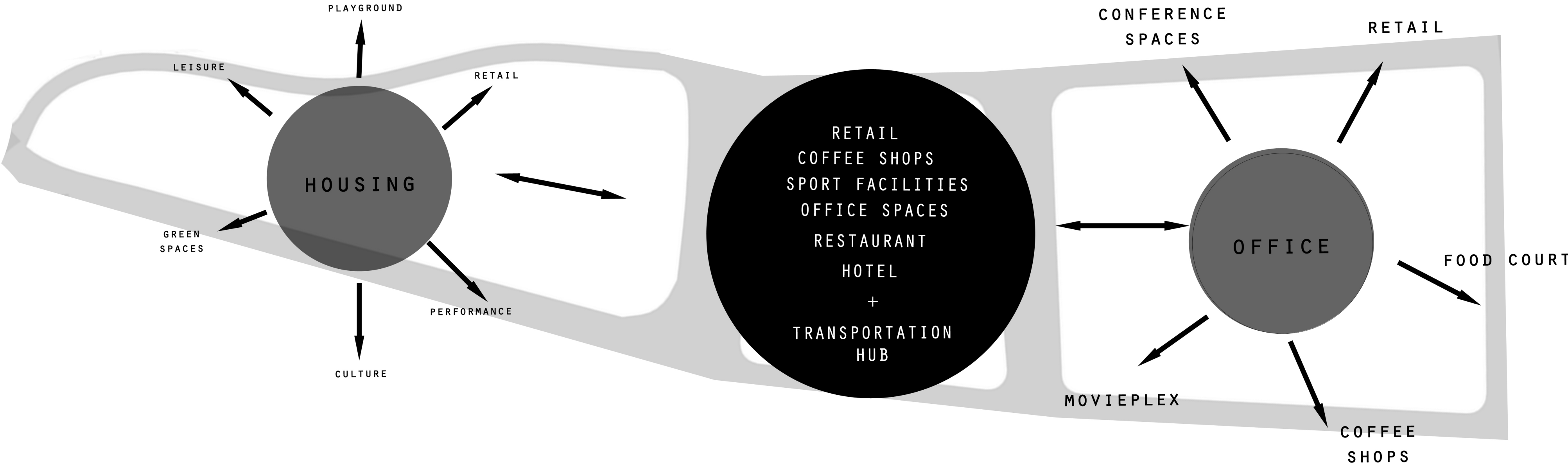
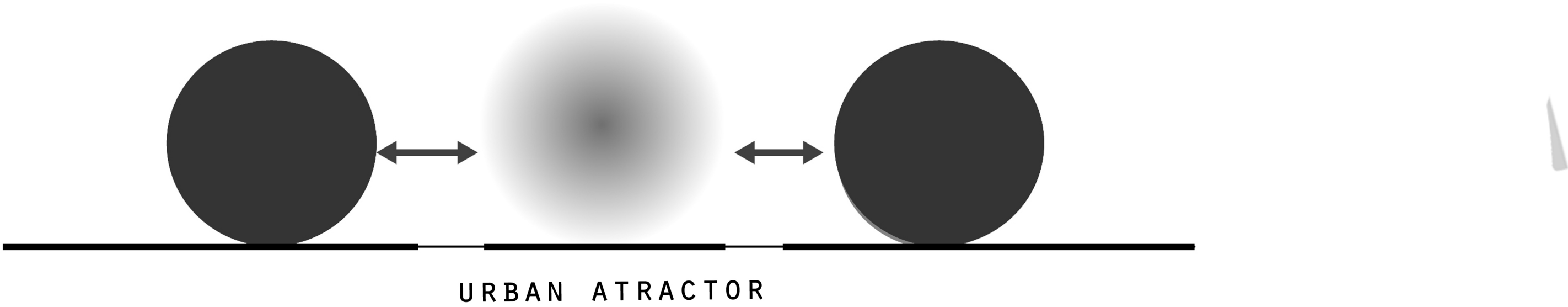

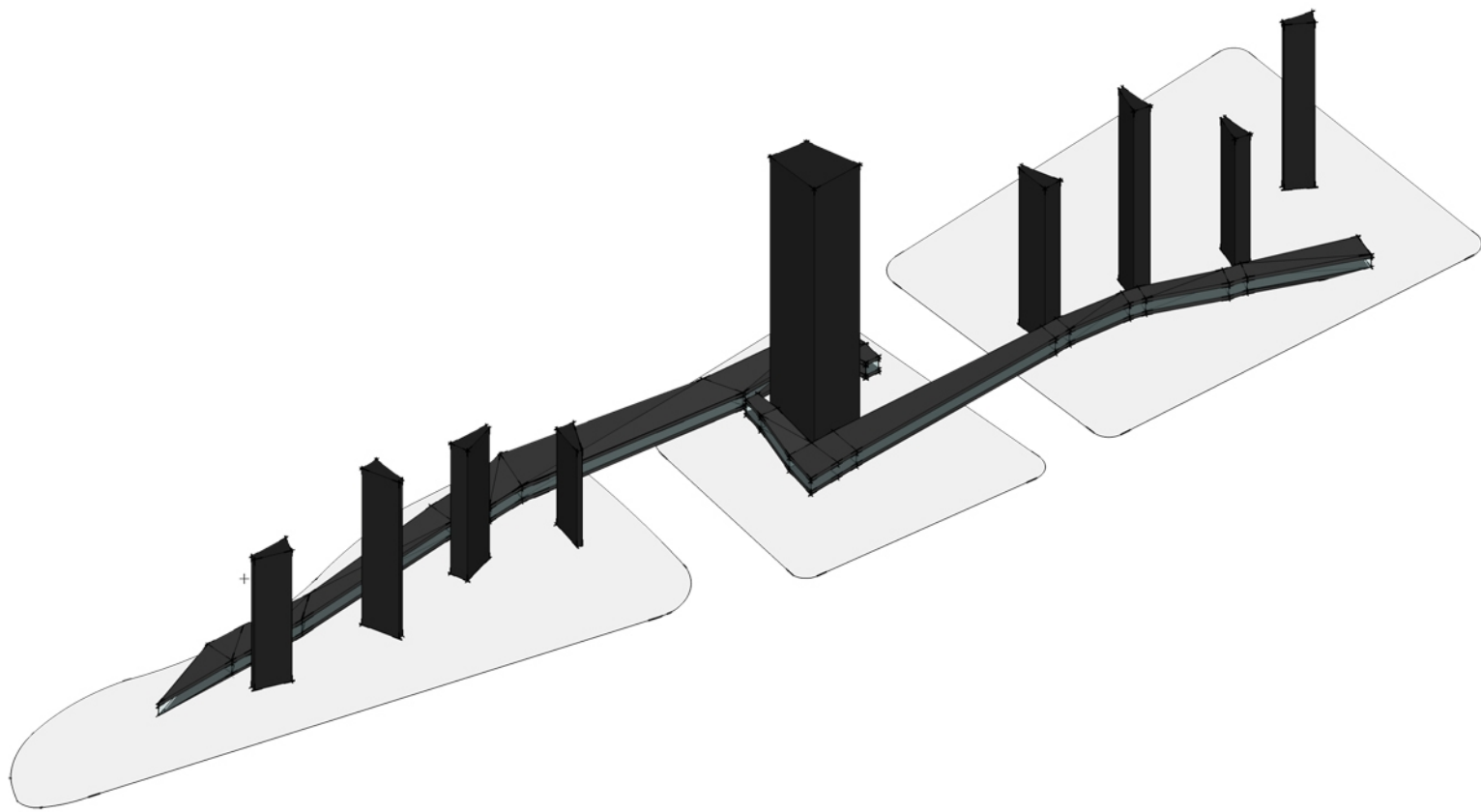

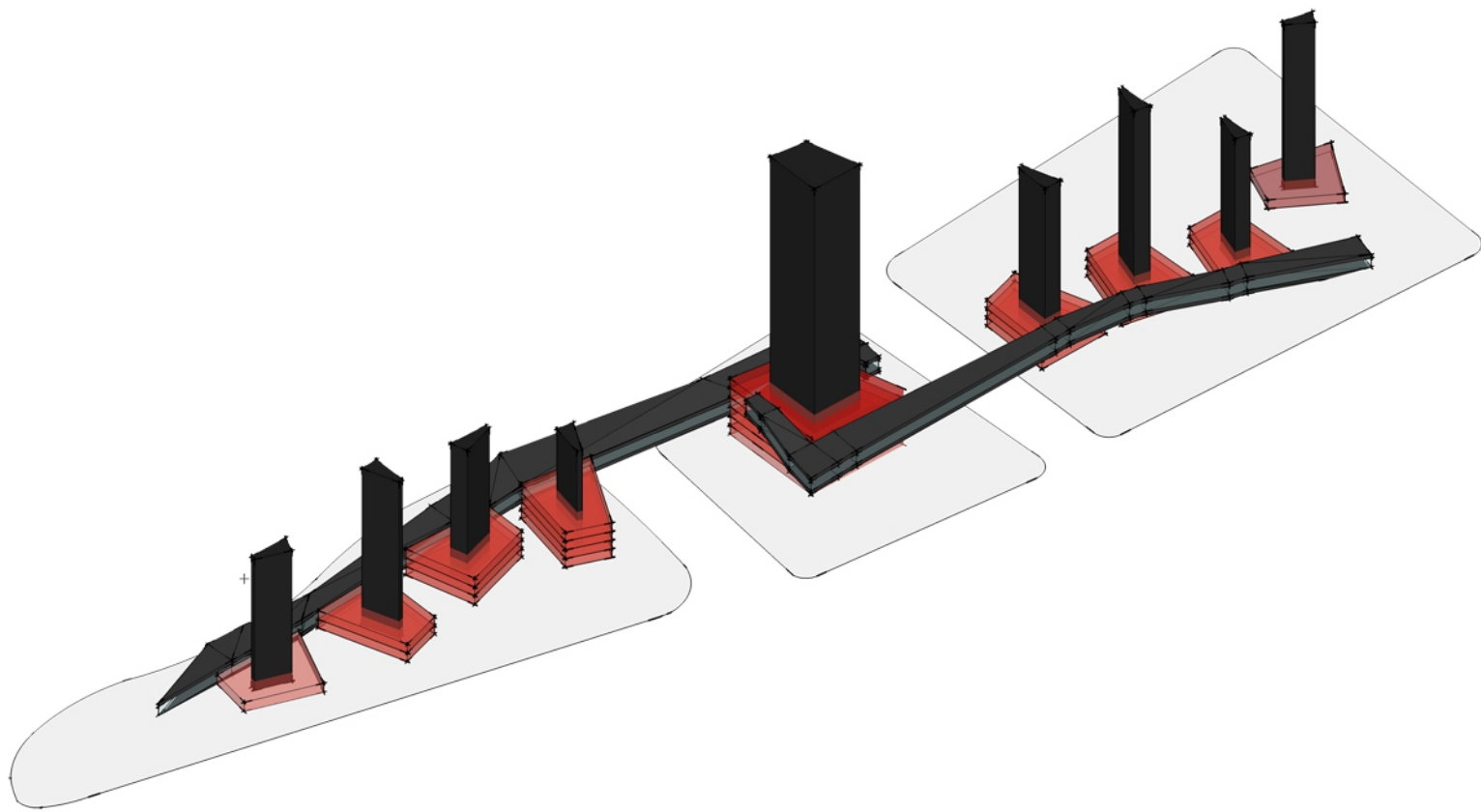

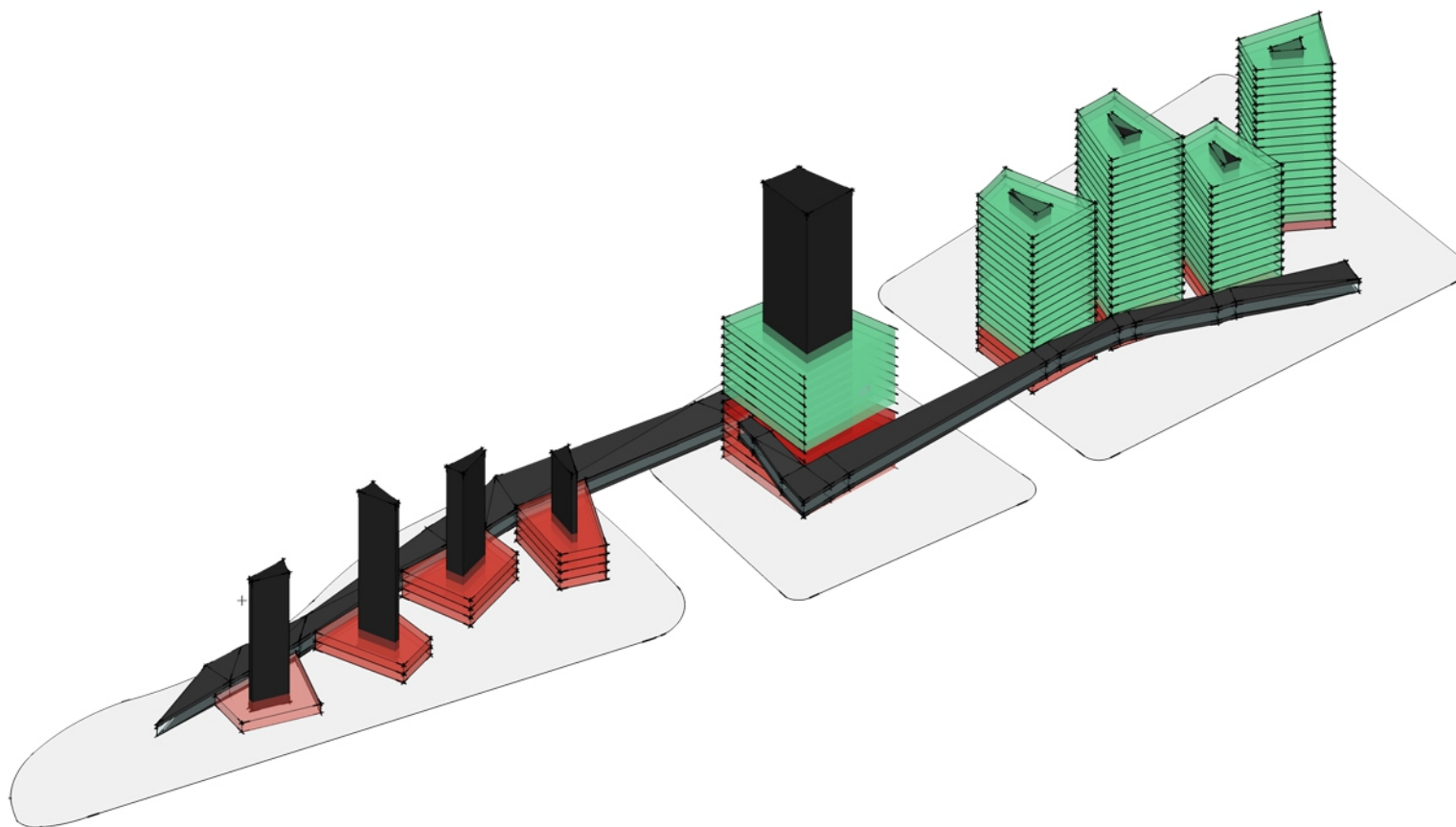

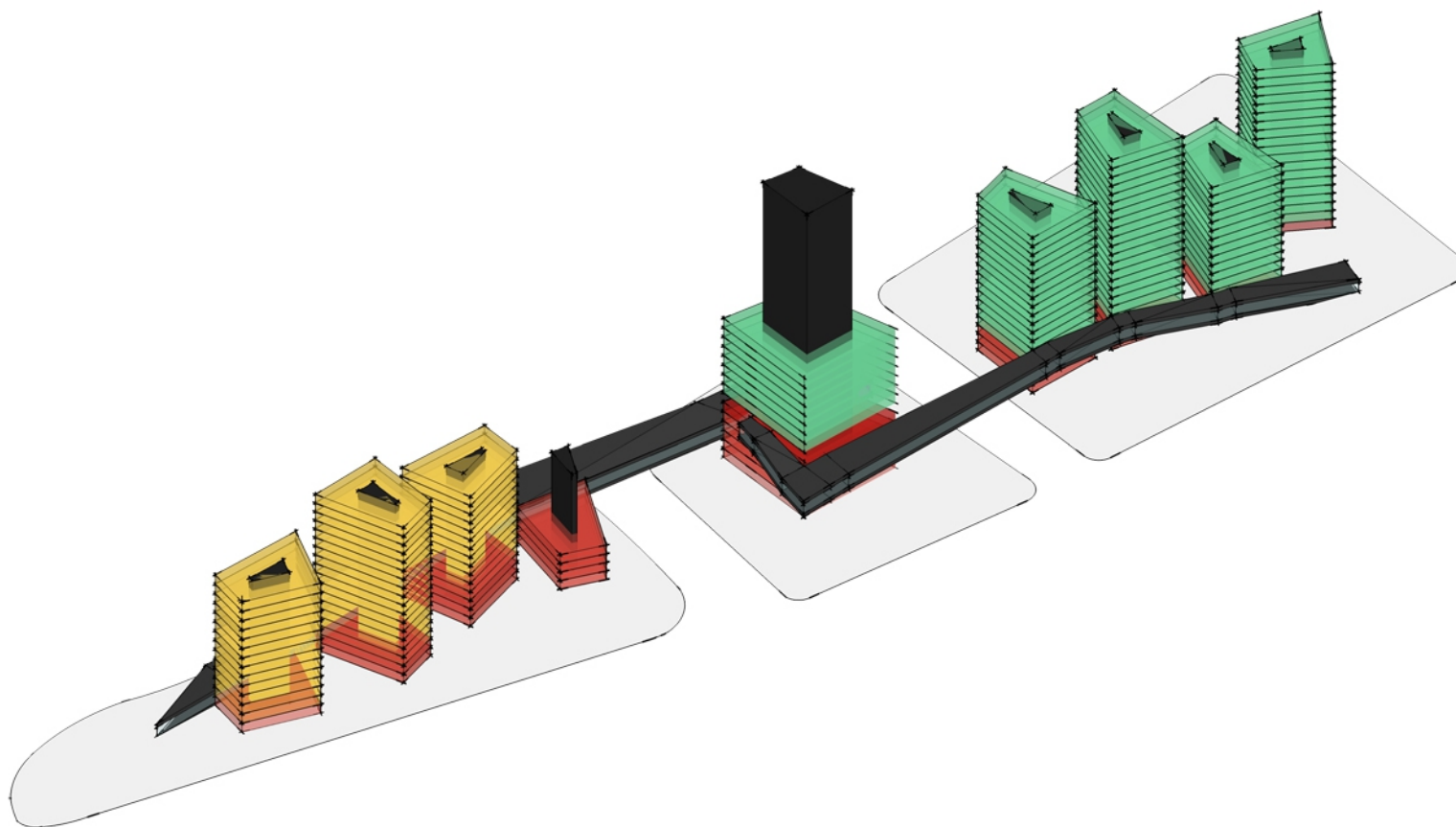

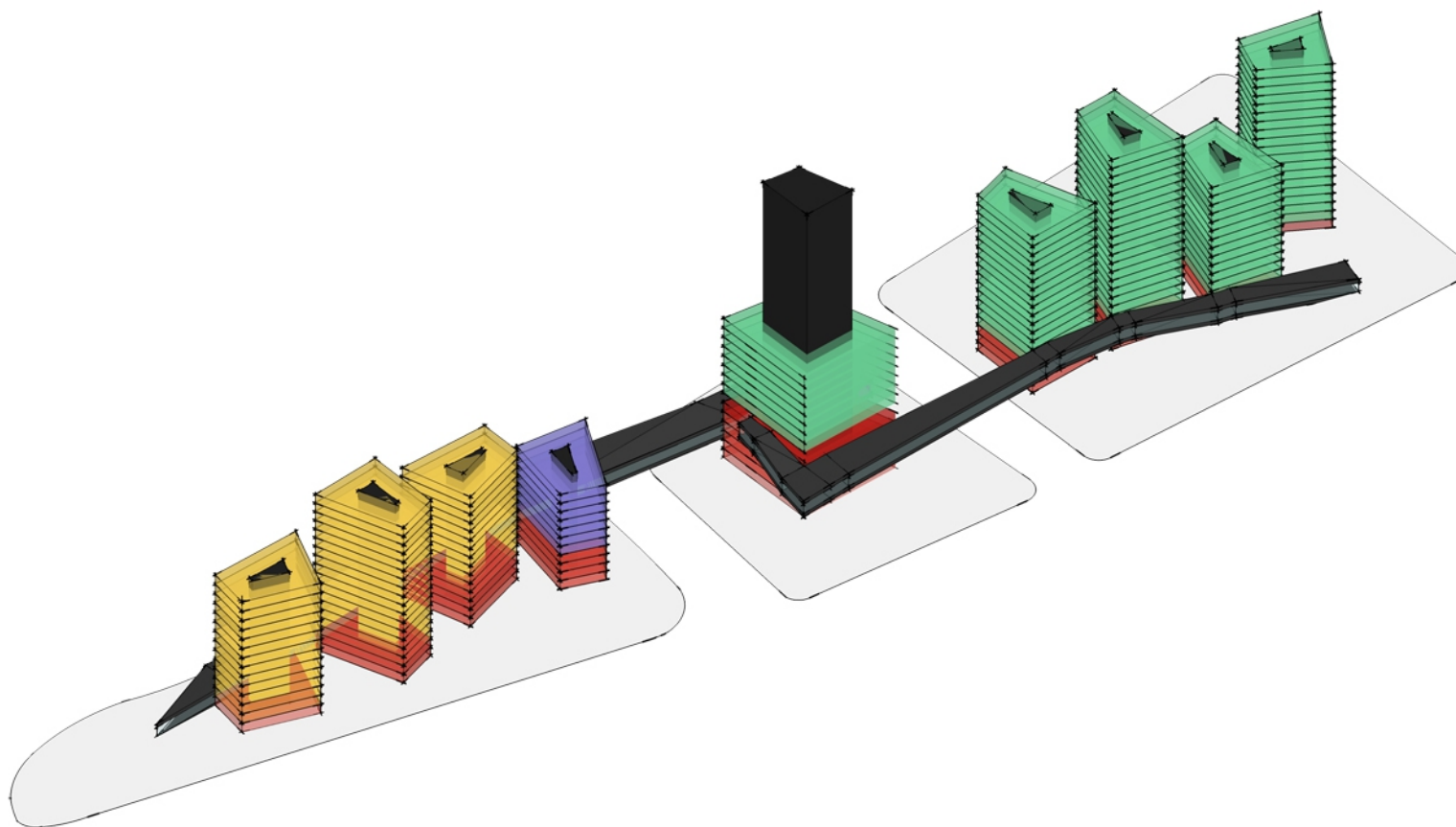

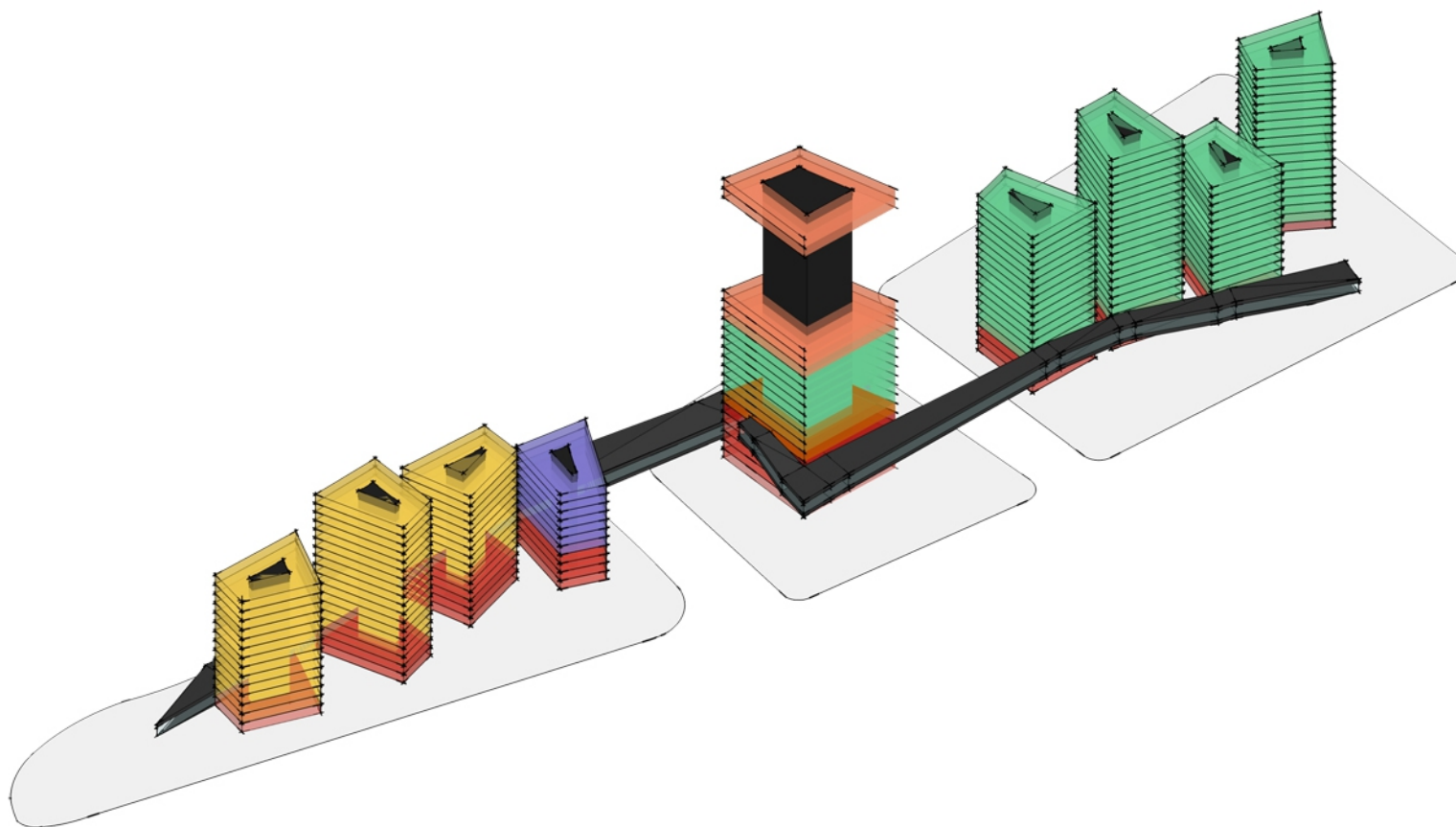

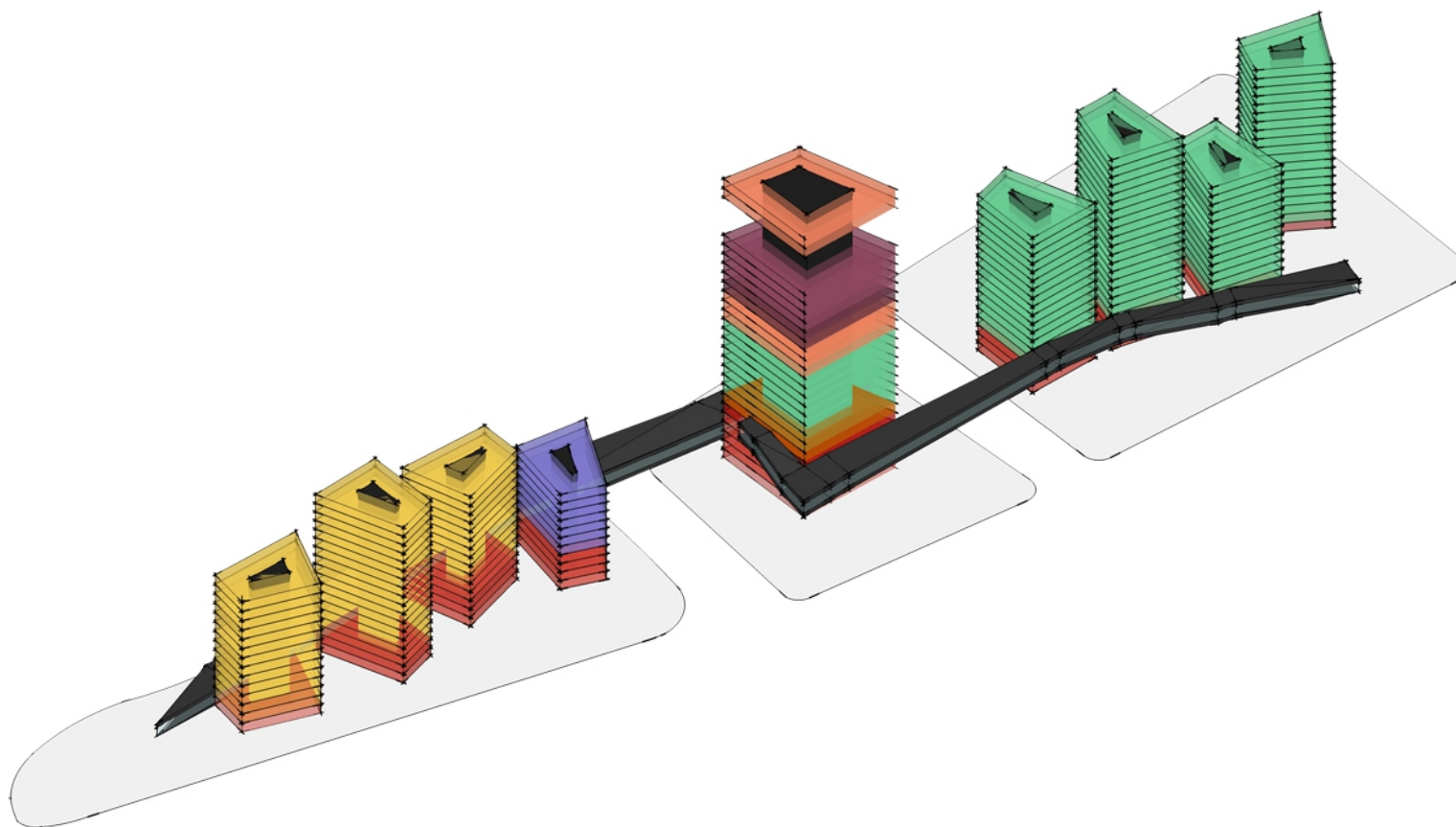

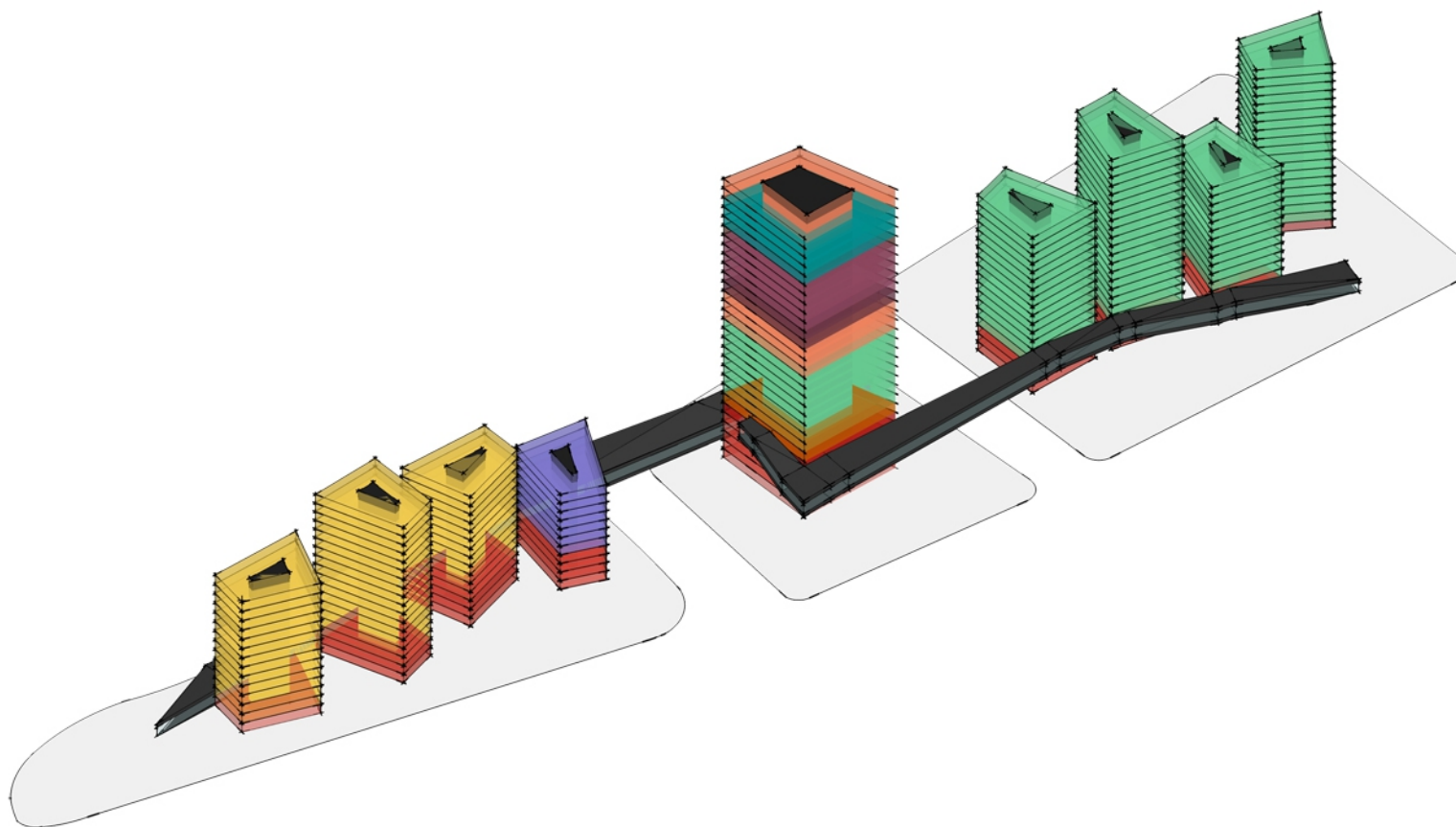

- residential
- retail\_services
- culture
- offices
- cultura
- sports\_leisure
- pool\_area
- medical\_services
- restaurant\_cafe
- administration

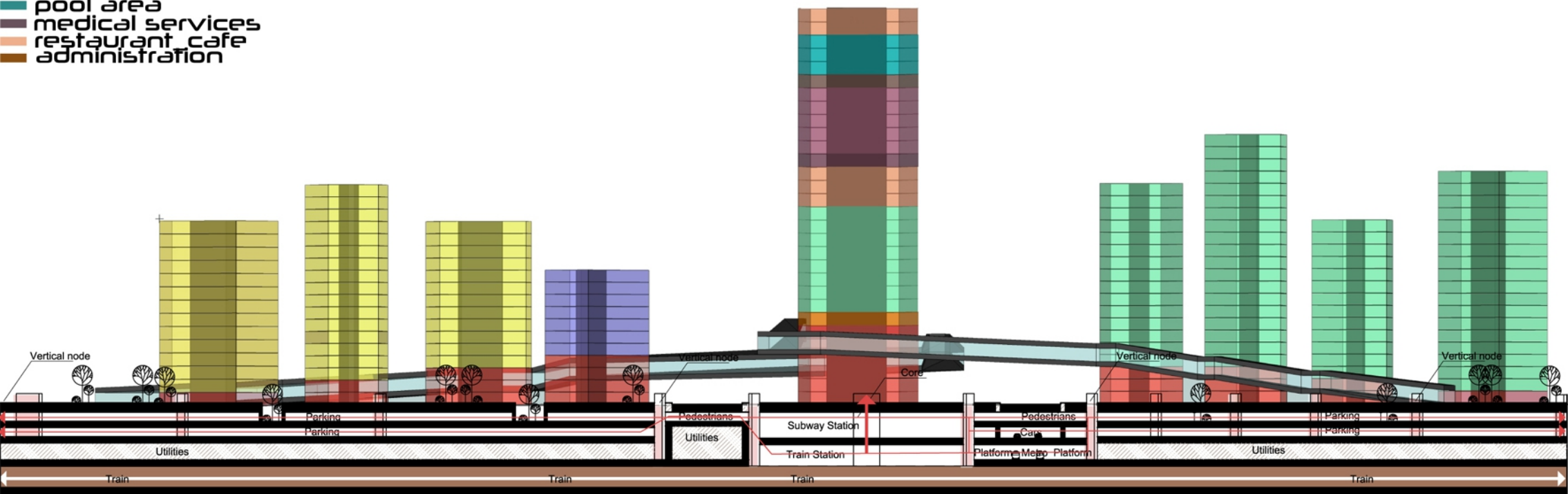



SITE PLAN

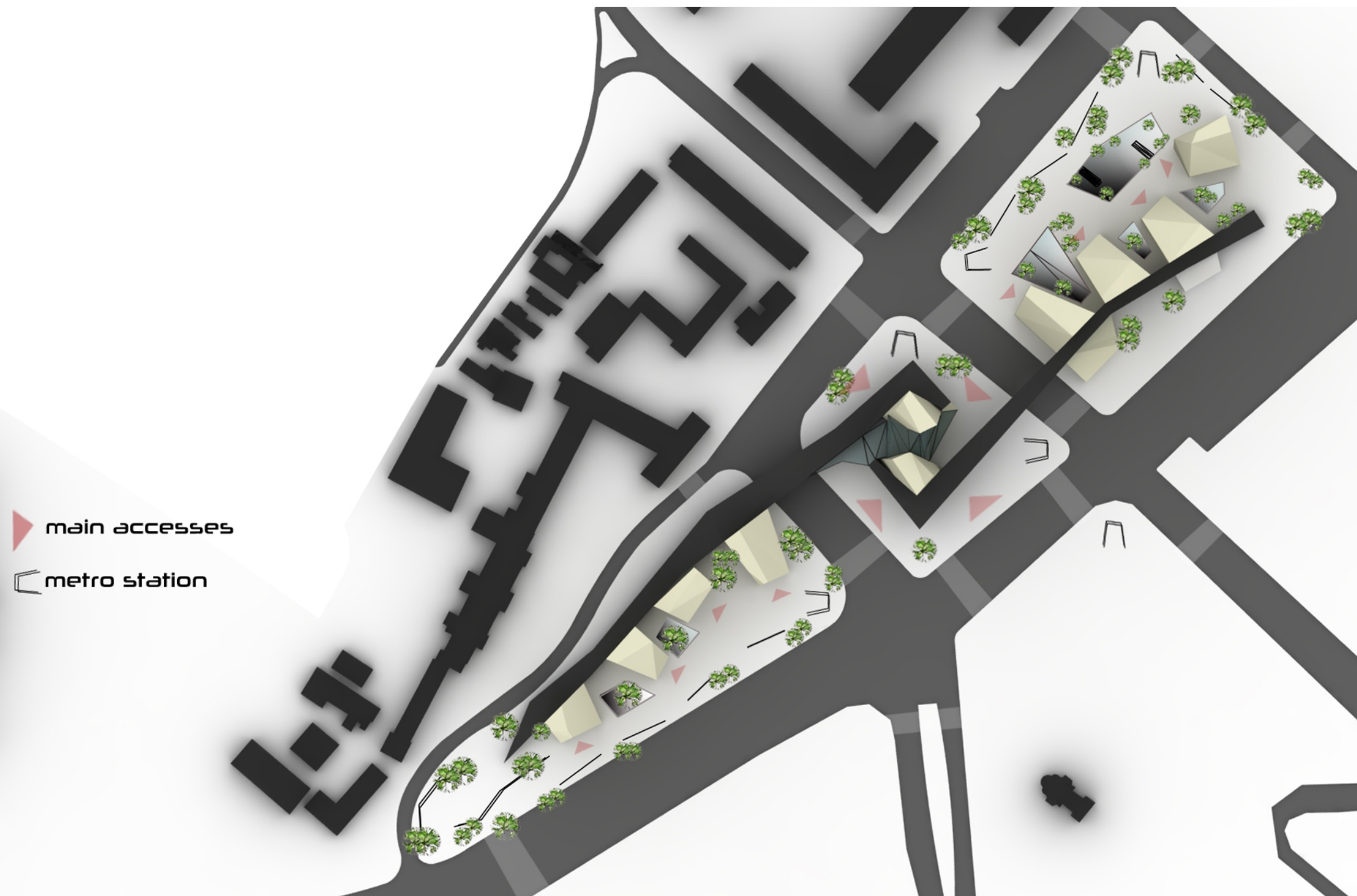

SITE PLAN

